

Positive Inline Choke

Schlumberger

Positive inline choke.

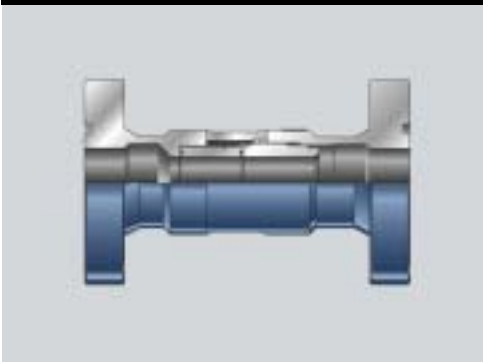

The positive inline choke incorporates a fixed bean design that allows the bean to be easily replaced without removing the valve body from the flow line. The unique inline design characteristics permit bidirectional flow. Maximum working pressure of the choke is 5000 psi [34,475 kPa]. Line sizes are currently available in sizes to 8 in. [203.2 mm]. Bean sizes range from 1/2 to 3 in. [12.7 to 76.2 mm].

Applications

- Oil, gas, and water service

Benefits

- Bean replacement without removing valve body from service

Features

- Inline choke with fixed bean design
- Bidirectional flow