

## QUANTUM Guide Shoe

Used to ensure proper seal assembly entry into a production packer or polished bore receptacle (PBR)

### APPLICATIONS

- Standard completion operations

### BENEFITS

- Increases reliability for guiding seal assembly into sealbore
- Adapts to all Schlumberger seal assemblies
- Easily passes through packer bores or PBRs to streamline completion operations
- Serves as a wireline re-entry guide

### FEATURES

- NACE MR0175-compliant materials

Guide shoes are also designed to assist as a wireline re-entry guide as tools are run in and out of the assembly. Guide shoes should be used in any application where it is necessary to sting an assembly in or through another assembly. Guide shoes should not be used on applications where tubing rotation is difficult or prohibited.

QUANTUM\* gravel-pack packer guide shoes are manufactured from materials that comply with NACE MR0175 standards for sulfide stress cracking-resistant metallic materials.

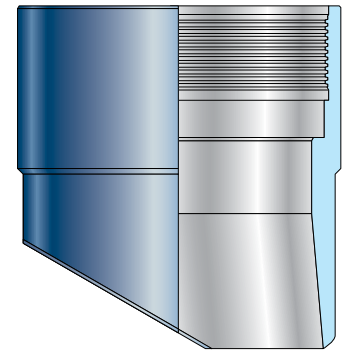

QUANTUM Guide Shoe.

### Quantum Guide Shoe Specifications

Size, <sup>†</sup> in [mm]	OD, in [mm]	ID, in [mm]
2.688 [68.3]	2.670 [67.8]	1.930 [49.0]
3.000 [76.2]	2.960 [75.2]	2.000 [50.8]
3.250 [82.6]	3.210 [81.5]	2.370 [60.2]
4.000 [101.6]	3.230 [82.0]	3.030 [77.0]
4.750 [120.7]	4.710 [119.6]	3.200 [81.3]
6.000 [152.4]	5.970 [151.6]	4.740 [120.4]

<sup>†</sup> Other sizes are available on request. Contact your local Schlumberger representative.