

# 414 CENTRIFUGE



## FEATURES

- Balanced scroll design
- High centrifugal force
- Efficient operation
- Stainless steel bowl
- Tungsten-carbide scroll points
- Precision balanced
- Operating safety controls protect against catastrophic failure
- Variable speed electro-hydraulic backdrive

## BENEFITS

- Recovers 95% of barite, minimizing costly additions while maintaining prescribed mud weights
- Rejects finer, low-gravity solids from drilling fluids
- Cost-efficient operation — reduces discard volume versus dilution displacement alternatives 30 to 60% depending upon mud weights
- Ideal for use with weighted or unweighted mud systems
- Rugged construction and corrosion-resistant materials provide long service life and low maintenance costs in the toughest oilfield environments

The M-I SWACO\* 414 CENTRIFUGE\* delivers high performance and low operating costs for oilfield and industrial mud and fluids-handling applications.

This highly efficient decanting centrifuge recovers 95% of barite and returns it to the active system, while rejecting finer, low-gravity solids. The advanced design of the stainless steel bowl and scroll maintains an even layer of conveyed solids for more uniform separation and maximum solids-control efficiency.

## Features

**Balanced scroll design** increases recovery capacity

**High centrifugal force** generates centrifugal force of 500 G's at its operating speed of 1,600 RPM while processing up to 140 GPM (530 L/min)

**Efficient operation** processes up to 140 GPM (530 L/min) with a 6- to 10-micron cut on weighted mud systems; processes up to 250 GPM (946.4 L/min) with a 5- to 7-micron cut point on unweighted mud

**Stainless steel bowl, scroll compartment and cover** to resist corrosion and abrasion

**Tungsten-carbide scroll points** with wide spacing flights at the narrow end create a finer layer of conveyed solids for more uniform separation under high G-forces

**Precision balanced** to run at high RPMs for extended periods with greater efficiency, minimizing maintenance and downtime

**Operating safety controls** include self-limiting vibration and torque switches to protect against catastrophic failure

**Variable speed electro-hydraulic backdrive** is available as an option for the 414 CENTRIFUGE

## Specifications

Bowl Size in. (mm)	Length in. (mm)	Width in. (mm)	Height in. (mm)	Weight lb (kg)	hp
14 x 34	95.4	70	34.1	4,040	25/7.5
356 x 864	2,423.2	1,778	866.1	1,832	



The M-I SWACO 414 CENTRIFUGE — precision equipment engineered to handle rugged oilfield service.

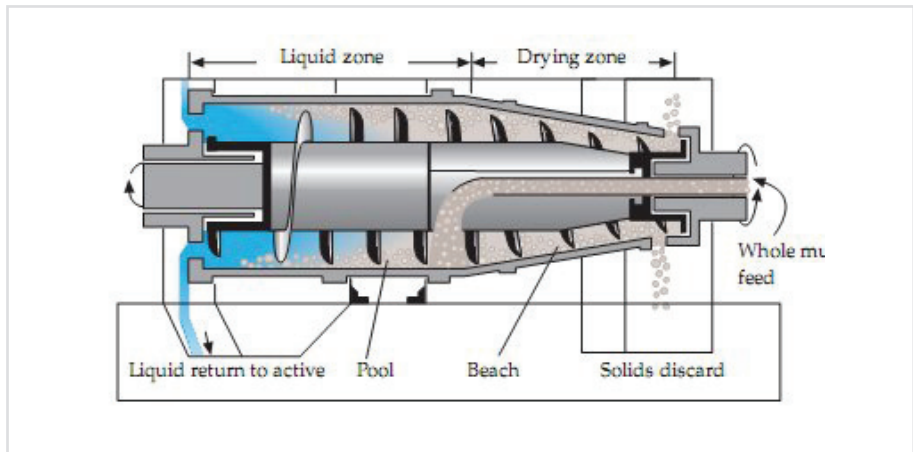

### Engineering Drawing: 414 CENTRIFUGE

All dimensions are expressed in inches (millimeters).

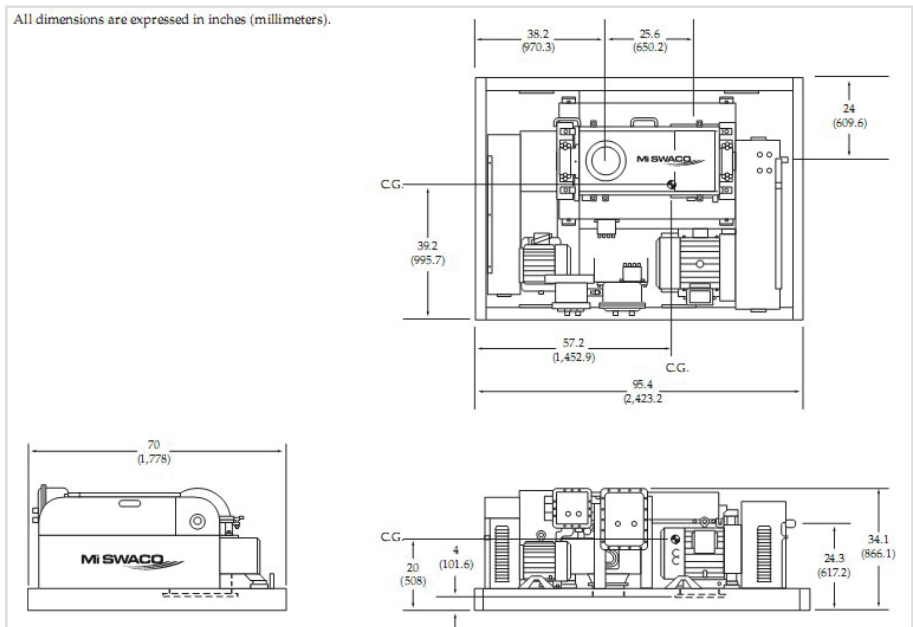

This information is supplied solely for informational purposes and M-I SWACO makes no guarantees or warranties, either expressed or implied, with respect to the accuracy and use of this data. All product warranties and guarantees shall be governed by the Standard Terms of Sale.



A Schlumberger Company

P.O. Box 42842  
Houston, Texas 77242-2842

Tel: 281-561-1300

Fax: 281-561-1441

www.miswaco.com

E-mail: questions@miswaco.com